

Grow Tent Assembly Instructions



STEP 1:

Create Floor and Roof by placing "A" poles together using corners

NOTE:

Firmly push poles completely into corner pieces

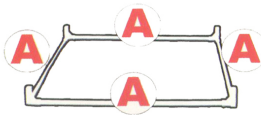

STEP 2:

Attach four "B" poles to Floor part

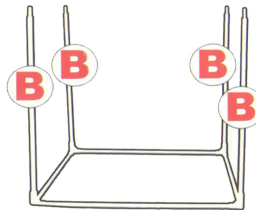

STEP 3:

Attach four "C" poles to Roof part

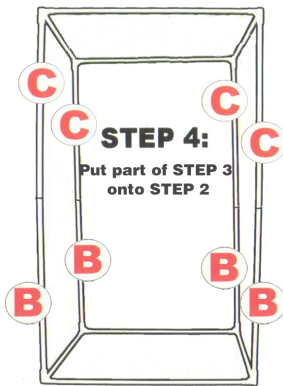
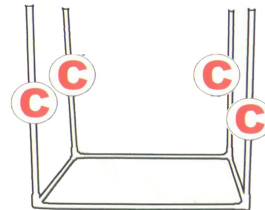

STEP 4:

Put part of STEP 3 onto STEP 2

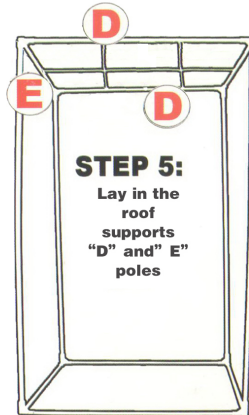

STEP 5:

Lay in the roof supports "D" and "E" poles

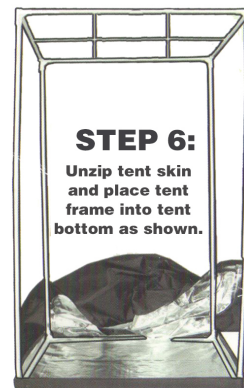

STEP 6:

Unzip tent skin and place tent frame into tent bottom as shown.

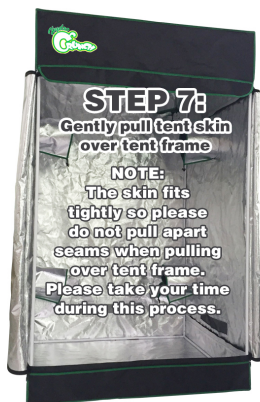

STEP 7:

Gently pull tent skin over tent frame

NOTE:

The skin fits tightly so please do not pull apart seams when pulling over tent frame. Please take your time during this process.



STEP 8:

Put floor insert inside tent. Use the straps to hold the floor insert to poles.



STEP 9:

Zip up the door to complete

Congratulations! Your grow tent is now created.

Please add on lightings, ventilation, plants, and start growing.

For more products please visit www.HydroCrunch.com

48*48*80in

